

## Overview

---

Divides the control line from host devices such as the Yamaha MTX/MRX series into up to 8 lines.

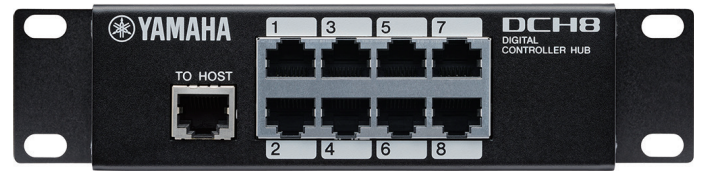

## Features

---

- Functions as a relay device between the host device and DCP series
- Allows a combination of star and daisy-chain connections.
- Power is supplied via the CAT5e cable from the host device, simplifying cabling and allowing flexible device layout.
- The distance between the host device and the furthest control panel must be less than 200 meters.
- Screw holes for the mounting flanges are provided on both the rear and sides, for flexible mounting in a variety of situations.

## Specifications

---

### General Specifications

<b>Operating Temperature</b>	0°C to +40°C
<b>Storage Temperature</b>	-20°C to +60°C
<b>Dimensions (WxHxD)</b>	132mm x 42mm x 44mm (5.2" x 1.65" x 1.73")
<b>Net Weight</b>	0.24kg (0.5lbs)

### Maximum Number of Device Connections per Host

<b>Host Device</b>	<b>Max. Number of Connections</b>
MTX3 MTX5-D MRX7-D	DCH8= 7 Control panel=8
MA2120 PA2120	DCH8=1 Control panel=2

## Dimensions

Unit: mm (inch)

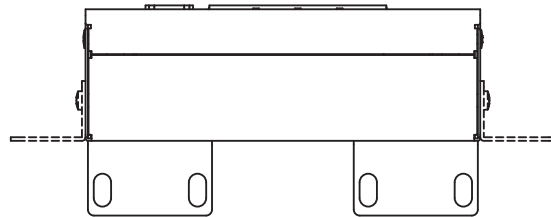
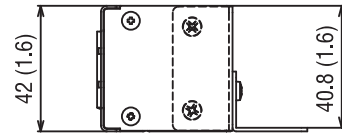
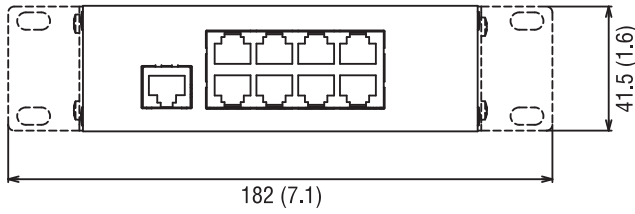
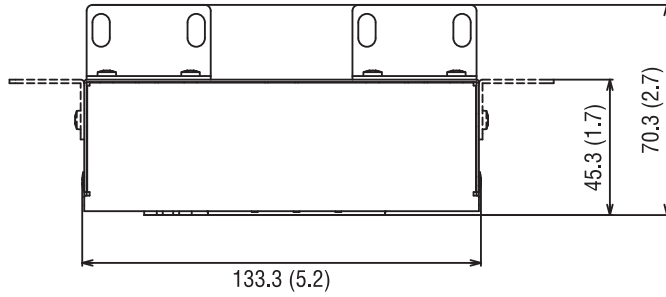

\*All information subject to change without notice.  
\*All trademarks and registered trademarks are property of their respective owners.  
Created in March, 2017